

CONTINUOUS HINGE

**DETAIL B
SCALE 1 : 3**

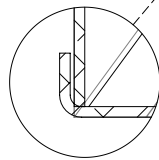

**DETAIL C
SCALE 1 : 3**

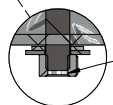

**NUT IS FUSED TO BOTTOM
END OF THREADED ROD**

**DETAIL F
SCALE 1 : 3**

SECTION A-A

CUSTOMER:

CODE: **TRBAT202416SP**
DESCR: **Stacking battery box**

DWG NO: **TRBAT202416SP-REVC**

MATERIAL: **0.125" Alum. Checkerplate**
TOLERANCES: **.xx ± 0.13" .xxx ± 0.010"**

REVISIONS		
REV.	DESCRIPTION	DATE
-	See Sheet1	-

APPROX. WEIGHT: **41.60 LB**

DATE: **2/23/2018**

SHEET SCALE: **1:12** SHEET SIZE: **8.5" x 11"** PAGE: **4 OF 4**

Dimensions are in inches unless otherwise specified



This Document is the sole property of **Trebor Manufacturing**